

SERIE VALLE | VALLE SERIES



natural
unglazed



<1,25%
máx. 2 mm



3-<E≤6%



3,7x10⁶x C⁻¹



18 N/mm²



<393 mm³



6



clase 3 a 5
class 3 to 5



Deslizam. CTE: clase 3
Slipping resist. CTE: class 3



C



R11

extrusión
EXTRUSION



Simbología y normas en pág. 183 Symbols and Standards p. 183
Los colores son indicativos Colours are just indicative

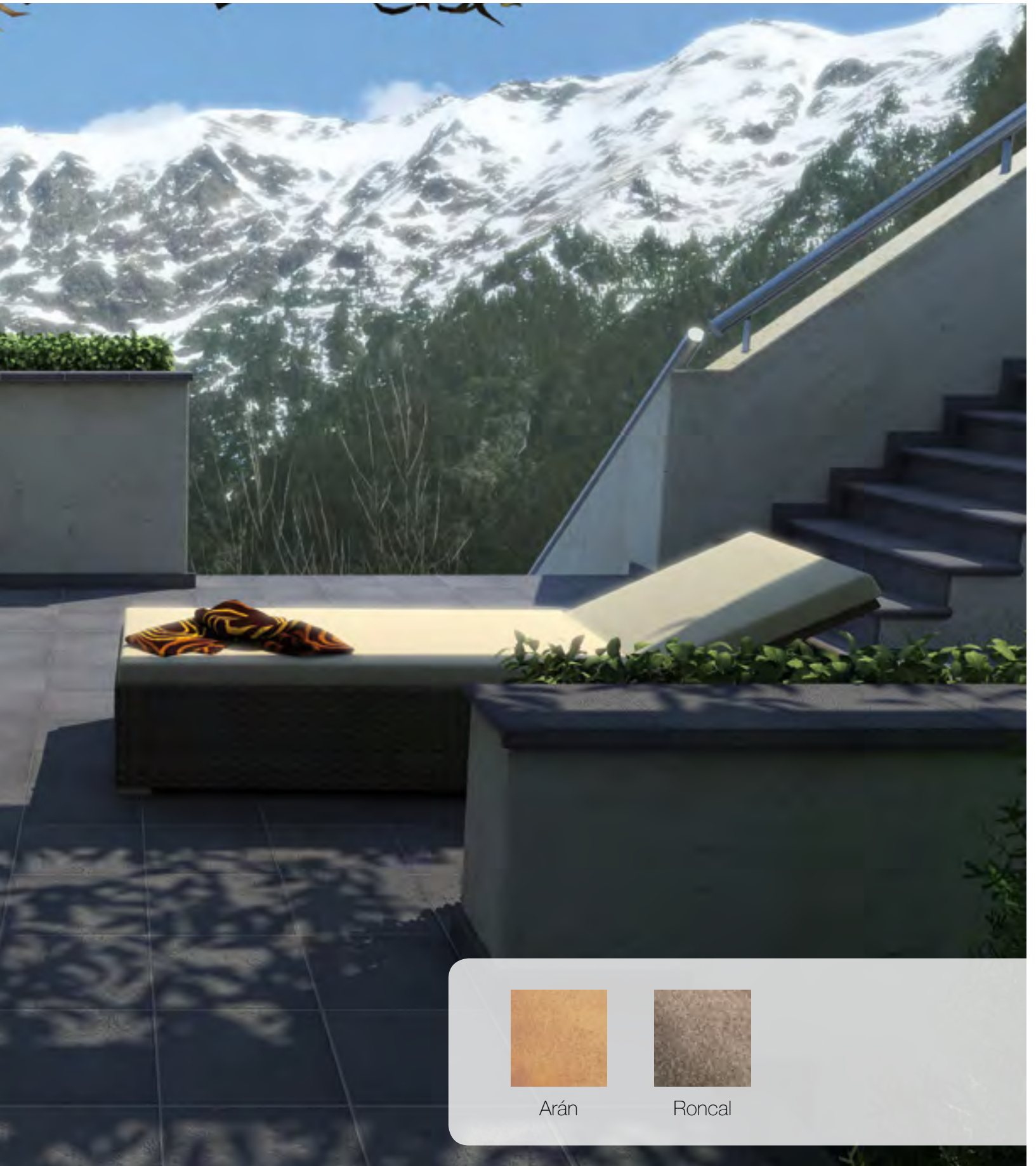

Arán

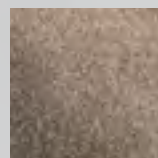

Roncal

Bases Basic pieces



Arán 33x33

Cod. 03059

MC625



Roncal 33x33

Cod. 03066

MC625

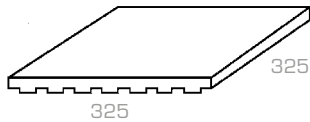

Base 33x33

Tile 33x33

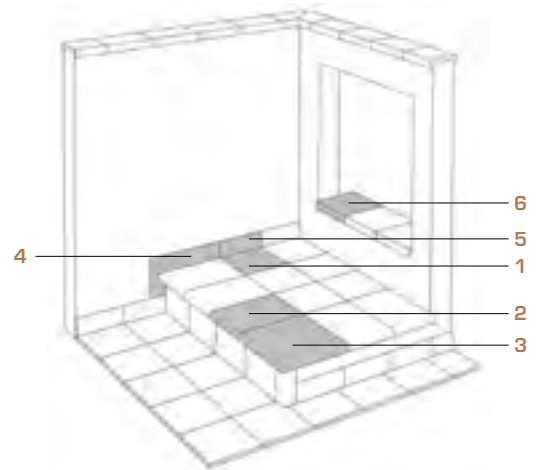

- | | | | |
|----------------------|--------------------|---------------|----------------|
| 1 Base | Tile | 4 Zanquín | String |
| 2 Peldaño | Stair-tread | 5 Rodapié | Skirting board |
| 3 Esquina de peldaño | Stair-tread corner | 6 Vierteaguas | Wash |

Artículo Item	Medidas (mm) Size (mm)	Espesor (mm) Thickness (mm)	U.M.*	U.M.*		Piezas Pieces		Peso (Kg) Weight (Kg)		
						U.M.*		U.M.*		
Base 33x33 Tile 33x33	325x325	16	M ² SQM	0,67	42,67	9	6	33	21,8	1400

* Unidad de Medida. Los artículos medidos en M² o ML se sirven contando la junta normal entre piezas
 *Unit of measure. Items measured in SQM or LM are delivered assuming average joint between pieces



Peldaño ref. 24-33
Stair-tread ref. 24-33



Arán ■ Cod. 03060
Roncal ■ Cod. 03067
PZ390

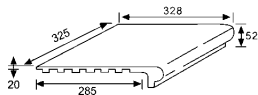

Esquina de peldaño
Stair-tread corner



Arán ■ Cod. 03062
Roncal ■ Cod. 03069
PZ640

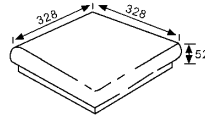

Remate
Edge



Arán ■ Cod. 03358
Roncal ■ Cod. 03361
PZ455



Vierteaguas 33x33
Wash 33x33



Arán ■ Cod. 03065
Roncal ■ Cod. 03072
PZ345

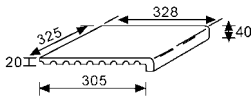

Zanquín izda.
String left side



Arán ■ Cod. 03063
Roncal ■ Cod. 03071
PZ190

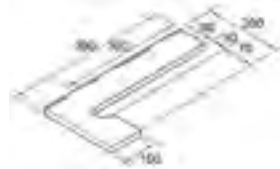

Zanquín dcha.
String right side



Arán ■ Cod. 03064
Roncal ■ Cod. 03070
PZ190

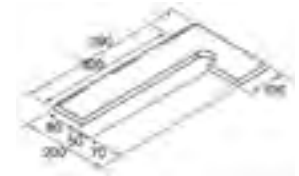

Rodapié 33
Skirting board 33





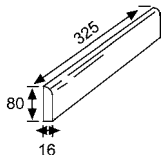



Arán ■ Cod. 03061
Roncal ■ Cod. 03068
ML190



Anchura recomendada de la junta de colocación: 6 - 8 mm
A 6 - 8 mm wide installation joint is recommended.



Arán/Roncal 33x33

Artículo Item	Medidas (mm) Size (mm)	Espesor (mm) Thickness (mm)	U.M.*	U.M.*		Piezas Pieces		Peso (Kg) Weight (Kg)		
						U.M.* 	U.M.* 	U.M.* 	U.M.* 	
Peldaño ref. 24-33 <i>Stair-tread ref. 24-33</i>	325x328x52	20	Pz. Pc.	6	216	1	6	4,2	25,1	906
Vierteaguas 33x33 <i>Wash 33x33</i>	325x328x40	20	Pz. Pc.	6	216	1	6	4,6	28	1020
Esquina de peldaño <i>Stair-tread corner</i>	328x328x52	20	Pz. Pc.	2	72	1	2	5,3	10,6	400
Zanquín izda. <i>String left</i>	390x80/200x100	16	Pz. Pc.	10	300	1	10	1,3	13	390
Zanquín dcha. <i>String right</i>	390x80/200x100	16	Pz. Pc.	10	300	1	10	1,3	13	390
Rodapié 33 <i>Skirting board 33</i>	325x80	16	ML LM	8	576	3	24	2,3	18	1296
Remate <i>Edge</i>	325x277x55	19	Pz. Pc.	4	168	1	4	5,01	20,04	865

*Unidad de Medida. Los artículos medidos en M² o ML se sirven contando la junta normal entre piezas
 *Unit of measure. Items measured in SQM or LM are delivered assuming average joint between pieces