

### P3 Comforts Design by Phoenix Design

**Bathtub rectangle, built-in or for panel, with one backrest slope left**  
 1/4" sanitary acrylic

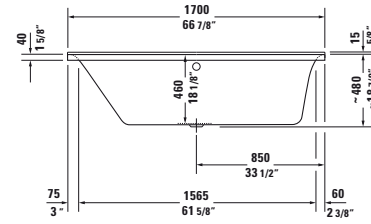
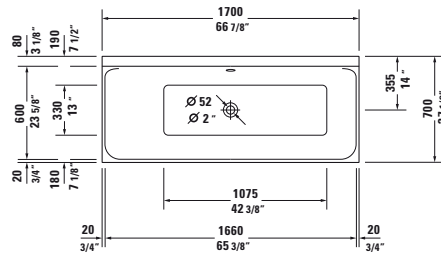

Length inch	Width inch	Depth/Height inch	Capacity gal	Weight lbs	Model-No.	USD
						White - 00
<b>Bathtub</b>						
66 7/8"	27 1/2"	18 1/8"	38.3	68.3	<b>700373 00 0 00 0090</b>	<b>960</b>
<b>Accessories for bath- and whirtub</b>						
Headrest, White					<b>790011 00 0 00 0000</b>	155
Bathtub anchors					<b>790103 00 0 00 0000</b>	65
Cable-driven waste and overflow, plastic, Chrome trim					<b>790219 00 0 00 1000</b>	225
Tile flange					<b>790112 00 0 00 0000</b>	225
Support frame, (included)					<b>790108 00 0 00 0000</b>	160
Suitable panels see page 438 - 439						

### P3 Comforts Design by Phoenix Design

**Bathtub rectangle, built-in or for panel, with one backrest slope left**  
 1/4" sanitary acrylic

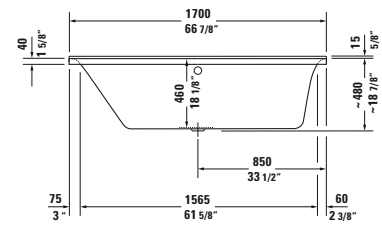
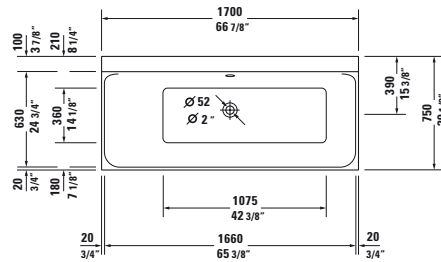

Length inch	Width inch	Depth/Height inch	Capacity gal	Weight lbs	Model-No.	USD
						White - 00
<b>Bathtub</b>						
66 7/8"	29 1/2"	18 1/8"	43.6	75.0	<b>700375 00 0 00 0090</b>	<b>985</b>
<b>Accessories for bath- and whirtub</b>						
Headrest, White					<b>790011 00 0 00 0000</b>	155
Bathtub anchors					<b>790103 00 0 00 0000</b>	65
Cable-driven waste and overflow, plastic, Chrome trim					<b>790220 00 0 00 1000</b>	200
Tile flange					<b>790112 00 0 00 0000</b>	225
Support frame, (included)					<b>790108 00 0 00 0000</b>	160
Suitable panels see page 438 - 439						

**P3 Comforts** Design by Phoenix Design

**Bathtub rectangle, built-in or for panel, with one backrest slope right**  
 1/4" sanitary acrylic

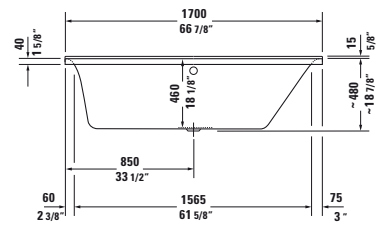
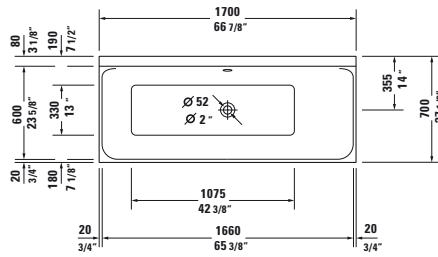

Length inch	Width inch	Depth/Height inch	Capacity gal	Weight lbs	Model-No.	USD
						White - 00
<b>Bathtub</b>						
66 7/8"	27 1/2"	18 1/8"	38.3	68.3	<b>700374 00 0 00 0090</b>	<b>960</b>
<b>Accessories for bath- and whirtub</b>						
Headrest, White					<b>790011 00 0 00 0000</b>	155
Bathtub anchors					<b>790103 00 0 00 0000</b>	65
Cable-driven waste and overflow, plastic, Chrome trim					<b>790219 00 0 00 1000</b>	225
Tile flange					<b>790112 00 0 00 0000</b>	225
Support frame, (included)					<b>790108 00 0 00 0000</b>	160
Suitable panels see page 438 - 439						

### P3 Comforts Design by Phoenix Design

**Bathtub rectangle, built-in or for panel, with one backrest slope right**  
 1/4" sanitary acrylic

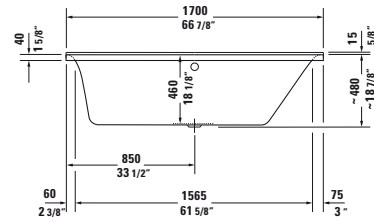
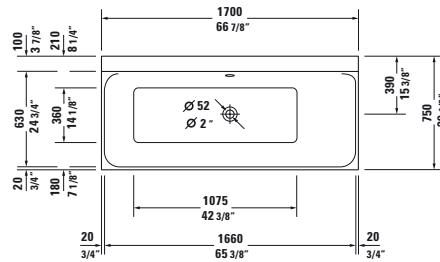

Length inch	Width inch	Depth/Height inch	Capacity gal	Weight lbs	Model-No.	USD
						White - 00
<b>Bathtub</b>						
66 7/8"	29 1/2"	18 1/8"	43.6	75.0	<b>700376 00 0 00 0090</b>	<b>985</b>
<b>Accessories for bath- and whirtub</b>						
Headrest, White					<b>790011 00 0 00 0000</b>	155
Bathtub anchors					<b>790103 00 0 00 0000</b>	65
Cable-driven waste and overflow, plastic, Chrome trim					<b>790220 00 0 00 1000</b>	200
Tile flange					<b>790112 00 0 00 0000</b>	225
Support frame, (included)					<b>790108 00 0 00 0000</b>	160
Suitable panels see page 438 - 439						

### P3 Comforts Design by Phoenix Design

**Bathtub rectangle, built-in or for panel, with two backrest slopes**  
 1/4" sanitary acrylic

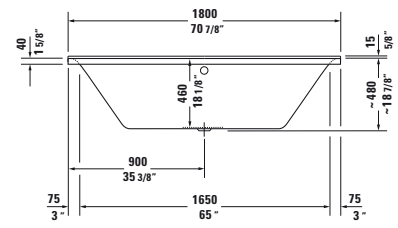
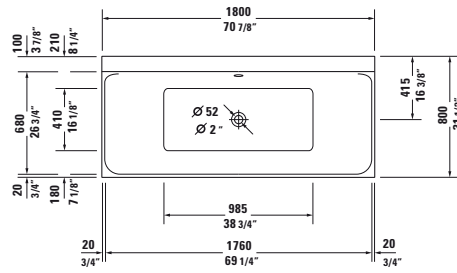

Length inch	Width inch	Depth/Height inch	Capacity gal	Weight lbs	Model-No.	USD
						White - 00
<b>Bathtub</b>						
70 7/8"	31 1/2"	18 1/8"	49.1	79.4	<b>700377 00 0 00 0090</b>	<b>1,075</b>
<b>Accessories for bath- and whirtub</b>						
Headrest, White					<b>790011 00 0 00 0000</b>	155
Bathtub anchors					<b>790103 00 0 00 0000</b>	65
Cable-driven waste and overflow, plastic, Chrome trim					<b>790220 00 0 00 1000</b>	200
Tile flange					<b>790112 00 0 00 0000</b>	225
Support frame, (included)					<b>790108 00 0 00 0000</b>	160
Suitable panels see page 438 - 439						

### P3 Comforts Design by Phoenix Design

**Bathtub rectangle, built-in or for panel, with two backrest slopes**  
 1/4" sanitary acrylic

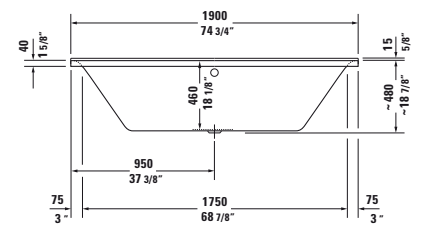
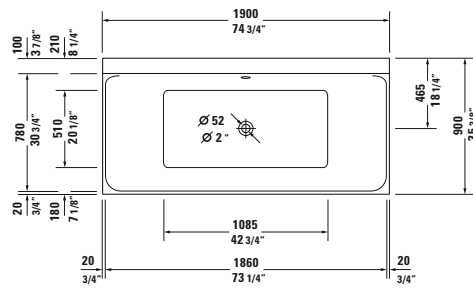

Length inch	Width inch	Depth/Height inch	Capacity gal	Weight lbs	Model-No.	USD
						White - 00
<b>Bathtub</b>						
74 3/4"	35 3/8"	18 1/8"	66.0	79.4	<b>700378 00 0 00 0090</b>	<b>1,290</b>
<b>Accessories for bath- and whirtub</b>						
Headrest, White					<b>790011 00 0 00 0000</b>	155
Bathtub anchors					<b>790103 00 0 00 0000</b>	65
Cable-driven waste and overflow, plastic, Chrome trim					<b>790220 00 0 00 1000</b>	200
Tile flange					<b>790112 00 0 00 0000</b>	225
Support frame, (included)					<b>790108 00 0 00 0000</b>	160
Suitable panels see page 438 - 439						

### P3 Comforts Design by Phoenix Design

**Bathtub corner left, with seamless acrylic panel and support frame, with two backrest slopes**  
 1/4" sanitary acrylic

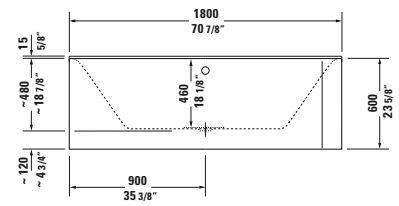
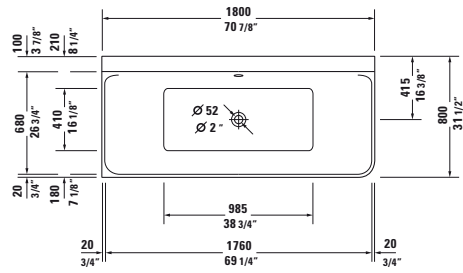

Length inch	Width inch	Depth/Height inch	Capacity gal	Weight lbs	Model-No.	USD
						White - 00
<b>Bathtub</b>						
70 7/8"	31 1/2"	18 1/8"	48.6	196.2	<b>700379 00 0 00 0090</b>	<b>3,535</b>
<b>Accessories for bath- and whirtub</b>						
Headrest, White					<b>790011 00 0 00 0000</b>	155
Bathtub anchors					<b>790103 00 0 00 0000</b>	65
Cable-driven waste and overflow, plastic, Chrome trim					<b>790220 00 0 00 1000</b>	200
Tile flange					<b>790112 00 0 00 0000</b>	225

### P3 Comforts Design by Phoenix Design

**Bathtub corner right, with seamless acrylic panel and support frame, with two backrest slopes**  
 1/4" sanitary acrylic

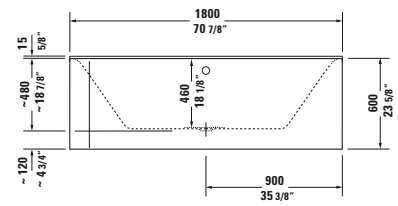
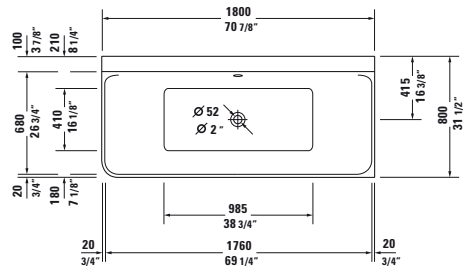

Length inch	Width inch	Depth/Height inch	Capacity gal	Weight lbs	Model-No.	USD
						White - 00
<b>Bathtub</b>						
70 7/8"	31 1/2"	18 1/8"	48.6	196.2	<b>700380 00 0 00 0090</b>	<b>3,535</b>
<b>Accessories for bath- and whirtub</b>						
Headrest, White					<b>790011 00 0 00 0000</b>	155
Bathtub anchors					<b>790103 00 0 00 0000</b>	65
Cable-driven waste and overflow, plastic, Chrome trim					<b>790220 00 0 00 1000</b>	200
Tile flange					<b>790112 00 0 00 0000</b>	225



### P3 Comforts Design by Phoenix Design

**Bathtub back-to-wall, with seamless acrylic panel and support frame, with two backrest slopes**  
 1/4" sanitary acrylic

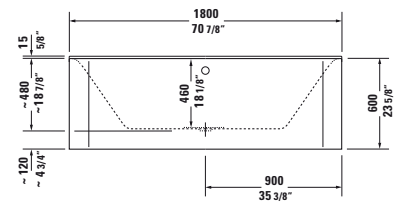
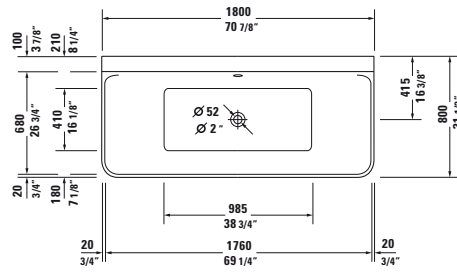

Length inch	Width inch	Depth/Height inch	Capacity gal	Weight lbs	Model-No.	USD
						White - 00
<b>Bathtub</b>						
70 7/8"	31 1/2"	18 1/8"	48.6	222.7	<b>700381 00 0 00 0090</b>	<b>3,740</b>
<b>Accessories for bath- and whirtub</b>						
Headrest, White					<b>790011 00 0 00 0000</b>	155
Bathtub anchors					<b>790103 00 0 00 0000</b>	65
Cable-driven waste and overflow, plastic, Chrome trim					<b>790220 00 0 00 1000</b>	200
Tile flange					<b>790112 00 0 00 0000</b>	225

**P3 Comforts Accessories** Design by Phoenix Design



Description	Model-No.	USD
	<b>Headrest</b>	
for P3 Comforts, material: polyurethane		
White	<b>790011 00 0 00 0000</b>	155

## P3 Comforts Design by Phoenix Design

### Product Information

<b>Panel</b>	<b>Decor</b>	<b>14</b> Terra <b>31</b> Pine Silver <b>43</b> Basalt Matt <b>49</b> Graphite Matt <b>51</b> Pine Terra <b>52</b> European Oak <b>53</b> Chestnut Dark <b>73</b> Ticino Cherry Tree <b>79</b> Natural Walnut	<b>Basic material:</b> High-density-fiberboard, with laminate (HPL) pressed on both sides.
	<b>Acryl</b> Pricegroup 1	<b>82</b> Acrylic White	<b>Basic material:</b> 3/8" Acryl solid-colored in white.
<b>Real wood veneer</b> Pricegroup 2	<b>13</b> American Walnut <b>24</b> Macassar <b>26</b> American Cherry Tree		<b>Basic material:</b> High-density-fiberboard, with real wood veneer pressed on one side and laminate (HPL) pressed on other side.  Real wood veneer is a natural material, differences in color and structure may occur.
	<b>Real wood veneer</b> Pricegroup 3	<b>05</b> Oak <b>12</b> Brushed Oak <b>69</b> Brushed Walnut <b>71</b> Mediterranean Oak <b>72</b> Brushed Dark Oak	<b>Basic material:</b> High-density-fiberboard, with real wood veneer pressed on one side and laminate (HPL) pressed on other side.  Real wood veneer is a natural material, differences in color and structure may occur.

### P3 Comforts Design by Phoenix Design

Description	inch	Model-No.	USD			
			Pricegroup 1	Pricegroup 2	Pricegroup 3	USD
						
<b>Panel</b>						
for corner left						
for # 7X0373 (66 7/8" x 27 1/2"),						
for # 7X0374 (66 7/8" x 27 1/2")	66 1/2" x 27 1/8"	<b>P3 8786</b>	1,225	1,665	1,935	
for # 7X0375 (66 7/8" x 29 1/2"),						
for # 7X0376 (66 7/8" x 29 1/2")	66 1/2" x 29 1/8"	<b>P3 8787</b>	1,225	1,665	1,935	
for # 7X0377 (70 7/8" x 31 1/2")	70 1/2" x 31 1/8"	<b>P3 8788</b>	1,225	1,665	1,935	
for # 7X0378 (74 3/4" x 35 3/8")	74 3/8" x 31 1/8"	<b>P3 8906</b>	1,295	1,760	2,055	
<b>Infobox:</b> The included support frame is required for the installation of the panel / Heights of P3 Comforts series: Height bathtub panel = 21 7/8", height bathtub panel incl. 5/8" shadow gap = 22 1/2", overall height incl. 1 5/8" bathtub rim = 24"						
						
<b>Panel</b>						
for corner right						
for # 7X0373 (66 7/8" x 27 1/2"),						
for # 7X0374 (66 7/8" x 27 1/2")	66 1/2" x 27 1/8"	<b>P3 8781</b>	1,225	1,665	1,935	
for # 7X0375 (66 7/8" x 29 1/2"),						
for # 7X0376 (66 7/8" x 29 1/2")	66 1/2" x 29 1/8"	<b>P3 8782</b>	1,225	1,665	1,935	
for # 7X0377 (70 7/8" x 31 1/2")	70 1/2" x 31 1/8"	<b>P3 8783</b>	1,225	1,665	1,935	
for # 7X0378 (74 3/4" x 35 3/8")	74 3/8" x 31 1/8"	<b>P3 8904</b>	1,295	1,760	2,055	
<b>Infobox:</b> The included support frame is required for the installation of the panel / Heights of P3 Comforts series: Height bathtub panel = 21 7/8", height bathtub panel incl. 5/8" shadow gap = 22 1/2", overall height incl. 1 5/8" bathtub rim = 24"						
						
<b>Panel</b>						
for back-to-wall						
for # 7X0373 (66 7/8" x 27 1/2"),						
for # 7X0374 (66 7/8" x 27 1/2")	66 1/2" x 27 1/8"	<b>P3 8776</b>	1,595	1,925	2,205	
for # 7X0375 (66 7/8" x 29 1/2"),						
for # 7X0376 (66 7/8" x 29 1/2")	66 1/2" x 29 1/8"	<b>P3 8777</b>	1,595	1,925	2,205	
for # 7X0377 (70 7/8" x 31 1/2")	70 1/2" x 31 1/8"	<b>P3 8778</b>	1,595	1,925	2,205	
for # 7X0378 (74 3/4" x 35 3/8")	74 3/8" x 31 1/8"	<b>P3 8902</b>	1,680	2,020	2,310	
<b>Infobox:</b> The included support frame is required for the installation of the panel / Heights of P3 Comforts series: Height bathtub panel = 21 7/8", height bathtub panel incl. 5/8" shadow gap = 22 1/2", overall height incl. 1 5/8" bathtub rim = 24"						

### P3 Comforts Design by Phoenix Design

Description	inch	Model-No.	USD			
			Pricegroup 1	Pricegroup 2	Pricegroup 3	
						
<b>Panel</b>						
for niche (alcove)						
for # 7X0373 (66 7/8" x 27 1/2"),						
for # 7X0374 (66 7/8" x 27 1/2"),						
for # 7X0375 (66 7/8" x 29 1/2"),						
for # 7X0376 (66 7/8" x 29 1/2")	66 1/2"	<b>P3 8938</b>	965	1,210	1,305	
for # 7X0377 (70 7/8" x 31 1/2")	70 1/2"	<b>P3 8939</b>	965	1,210	1,305	
for # 7X0378 (74 3/4" x 35 3/8")	74 3/8"	<b>P3 8941</b>	990	1,240	1,335	

**Infobox:** The included support frame is required for the installation of the panel / Heights of P3 Comforts series: Height bathtub panel = 21 7/8", height bathtub panel incl. 5/8" shadow gap = 22 1/2", overall height incl. 1 5/8" bathtub rim = 24"