

**Stonetto** Design by E00S

**Shower tray rectangle**  
DuraSolid Q

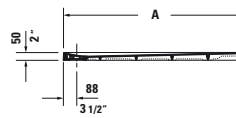
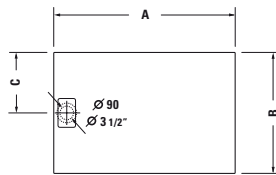

	A	B	C
<b>720145</b>	35 3/8"	31 1/2"	15 3/4"
<b>720145</b>	900	800	400
<b>720146</b>	35 3/8"	35 3/8"	17 3/4"
<b>720146</b>	900	900	450
<b>720147</b>	39 3/8"	31 1/2"	15 3/4"
<b>720147</b>	1000	800	400
<b>720148</b>	47 1/4"	31 1/2"	15 3/4"
<b>720148</b>	1200	800	400
<b>720149</b>	47 1/4"	35 3/8"	17 3/4"
<b>720149</b>	1200	900	450
<b>720150</b>	55 1/8"	35 3/8"	17 3/4"
<b>720150</b>	1400	900	450

Length inch	Width inch	Depth/Height inch	Weight lbs	Model-No.	USD
					White - 38 Sand - 48 Anthracite - 68
<b>Shower tray</b>					
35 3/8"	31 1/2"	2"	67.3	<b>720145 . . 0 00 0000</b>	1,075
35 3/8"	35 3/8"	2"	67.3	<b>720146 . . 0 00 0000</b>	1,130
39 3/8"	31 1/2"	2"	67.3	<b>720147 . . 0 00 0000</b>	1,170
47 1/4"	31 1/2"	2"	79.4	<b>720148 . . 0 00 0000</b>	1,240
47 1/4"	35 3/8"	2"	86.0	<b>720149 . . 0 00 0000</b>	1,280
55 1/8"	35 3/8"	2"	98.1	<b>720150 . . 0 00 0000</b>	1,375
<b>Accessories for shower tray</b>					
Tile flange				<b>790112 00 0 00 0000</b>	<b>225</b>

## Shower screen Product Information

### Tap side (example OpenSpace)

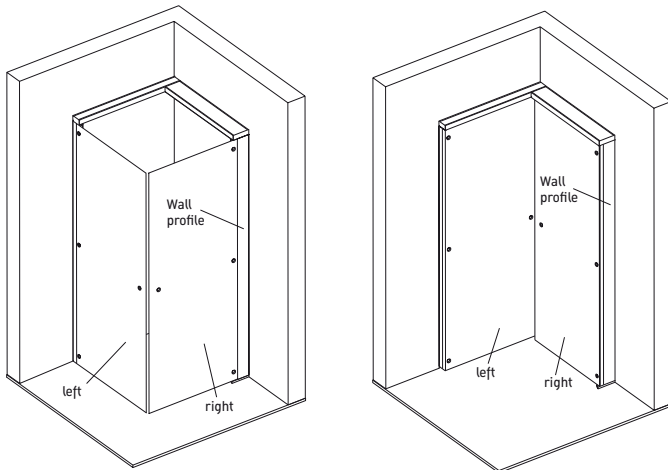

The glass doors of OpenSpace can be folded away after use, allowing OpenSpace to transform into a discreet wall panel which tidily conceals tap fittings and shower attachments.

The taps can be either positioned on the left or on the right side. The tap side is taken from the perspective of a person standing in front of the shower screen. For the type with tap left the deeper wall profile is assembled on the left. For the type with tap right the deeper wall profile is assembled on the right. Please consider this when ordering your OpenSpace / OpenSpace B shower screen. On site the tap side is no more changeable.

Before ordering a Duravit shower screen check the structural conditions with the help of the pre-installation data sheet.

### Selection of taps

The deeper wall profile is constructed for the assembly of taps. The tap parts on the wall can be up to 4 7/8" deep.

As a shower set consisting of shower bar and hand shower can have a depth of more than 4 7/8", a special quench holder with conical adapter is included in the delivery of every OpenSpace/OpenSpace B shower screen. Thus a multitude of standard hand showers are applicable and a clash of hand shower and glass folded towards the wall is avoided.

Please consider the instructions in the pre-installation data sheet for the selection of your taps.

### Water-tightness

The doors of OpenSpace/OpenSpace B directly rest on the shower tray or the tiled floor by the rise and fall hinge mechanism. Thereby a splash guard is largely achieved. Construction-conditioned, absolute water-tightness can't be ensured for frameless glass shower screens that are sealed by means of flexible plastic sealing strips.

Doors that can be opened outwards can cause water drops.

### Technical information

OpenSpace/OpenSpace B complies with the technical requirements of the valid EN 14428.

### Glass

3/8" toughened safety glass (OpenSpace B: 1/4") manufactured to EN 12150-1, transparent glass or optional mirror glass for tap side

### Profiles

Aluminum, finish chrome optics high-gloss, with rise and fall hinge mechanism, 180° swivelling range, OpenSpace B: Cover in compact laminate

### Application area

For shower trays or tiled shower areas

### Adjusting range

Vertical tolerances up to 3/4" (OpenSpace B: 1") can be adjusted.

### Quench holder

Chromed brass, included in delivery, only suitable for hand showers with conical adapter

### Door handle (only OpenSpace)

Chromed ABS, included in delivery, optionally mountable



Door handle (inside view)

### Installation dimensions

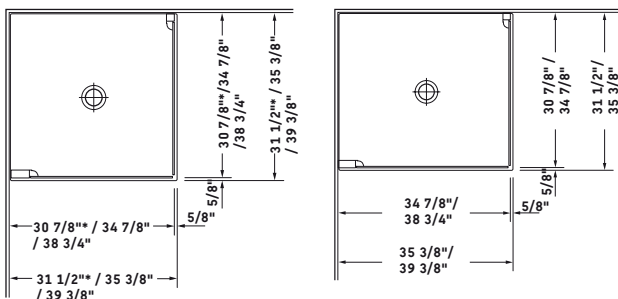

OpenSpace/OpenSpace B square, tap left  
(for tap right mirror-inverted)  
\* only OpenSpace

OpenSpace/OpenSpace B rectangle, tap left  
(for tap right mirror-inverted)

The figures show the required installation dimensions of the shower tray / area (= measured length dimension and width dimension from tiled wall to the front edge of the installed shower tray / area) for the available dimensions of OpenSpace/OpenSpace B.

The dimensions of OpenSpace/OpenSpace B consider that the shower screen is offset towards the inside by 5/8" from the outer edge of shower tray / area for the benefit of the water-tightness.