

KALDEWEI

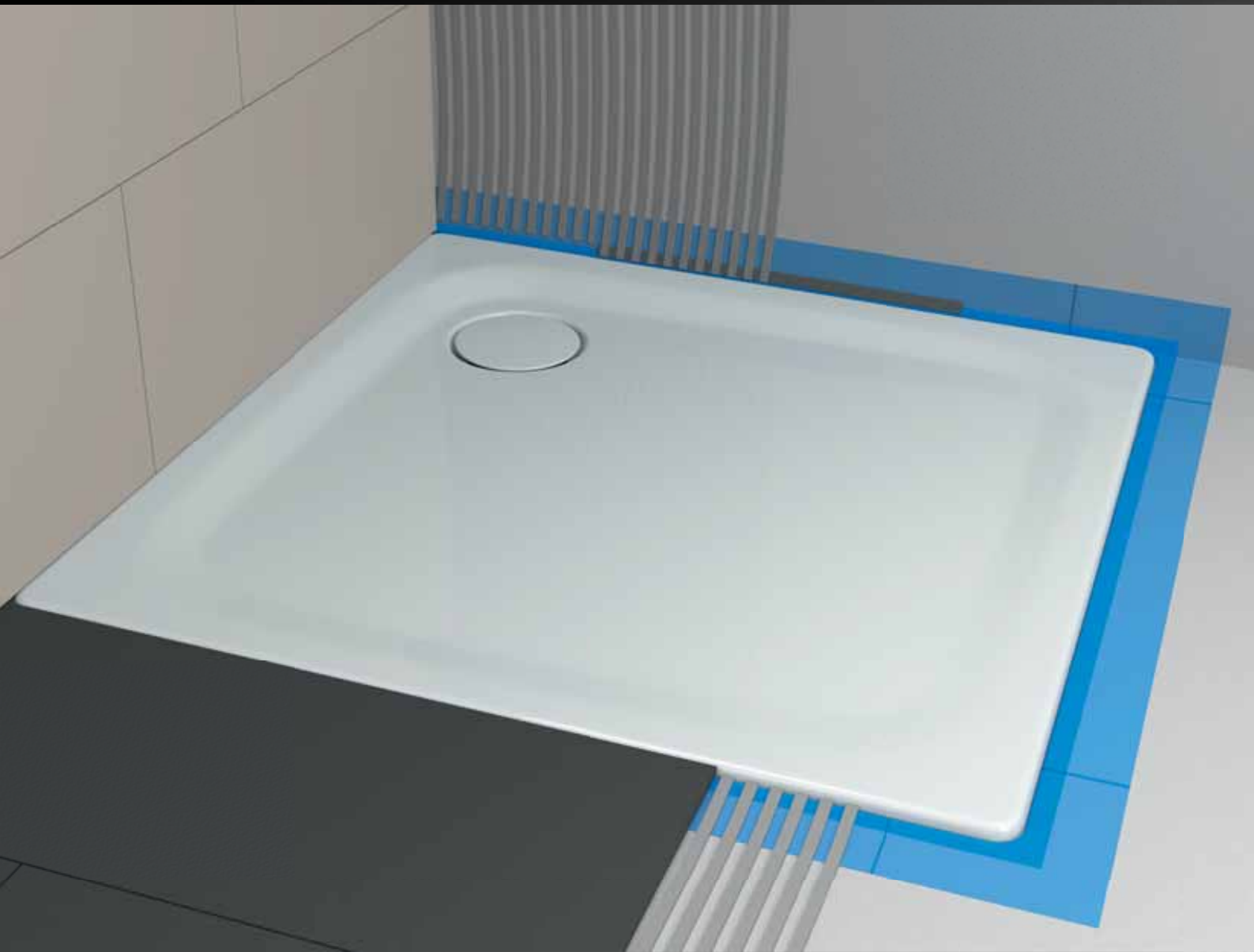

BATH AND SHOWER TRAY SEALING SYSTEM WDS

A system with all-round protection

BATH AND SHOWER TRAY SEALING SYSTEM WDS

The tray sealing system (WDS) protects Kaldewei silicon joints all the way round against penetrating moisture. The WDS is inserted between the edge of the bath or shower tray and the wall or floor and then tiled in. In case minute cracks form in the maintenance joints the tray sealing system (WDS) prevents moisture penetrating into the structure. This achieves more safety in the bathroom.

The WDS adapts to all possible situations and is available in graded lengths. It can be used for all-round sealing of built-in floor-flush shower trays. The strip is easy to attach and integrate into the usual follow-up sealing.

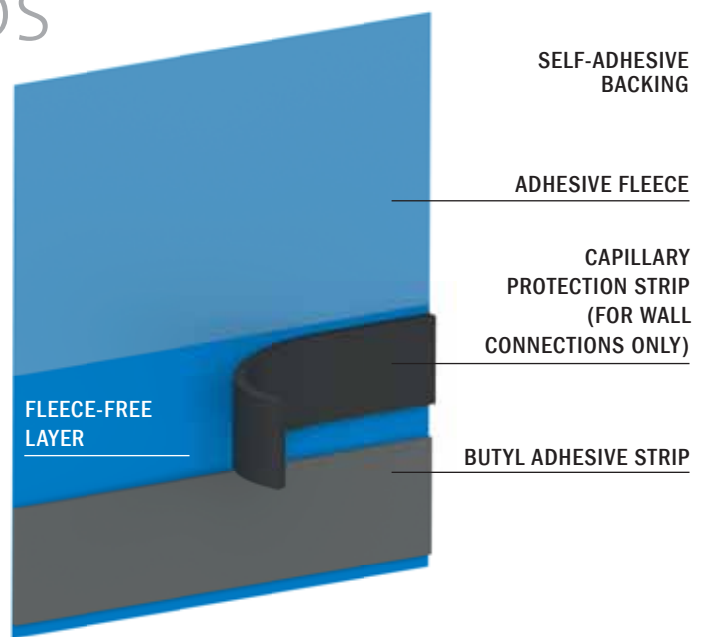

SCOPE OF SUPPLY

FOR RECTANGULAR SHOWER TRAYS

STANDARD SET 1 – Order no. 6876 7606 0000

(for shower trays of up to 3.6 m circumference)

- 1 x tray sealing strip 95 mm wide and 3.8 m long
- 4 x corner pieces 90°
- 1 x capillary protection strip 5.0 long
- 4 x capillary protection corners
- 1 x installation instructions
- 1 x notice sticker for tilers

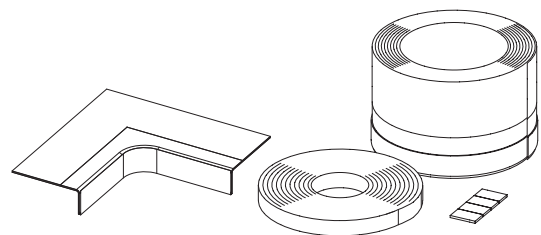

STANDARD SET 2 – Order no. 6876 7607 0000

(for shower trays of up to 4.8 m circumference)

- 1 x tray sealing strip 95 mm wide and 5.0 m long
- 4 x corner pieces 90°
- 1 x capillary protection strip 5.0 long
- 4 x capillary protection corners
- 1 x installation instructions
- 1 x notice sticker for tilers

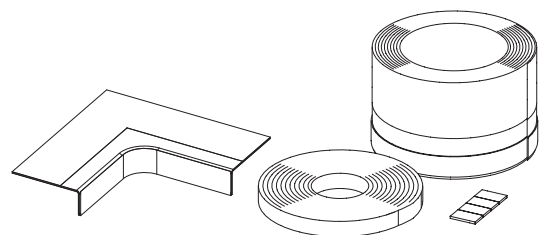

STANDARD SET 3 – Order no. 6876 7608 0000

(for shower trays of up from 4.8 m circumference)

- 1 x tray sealing strip 95 mm wide and 7.6 m long
- 4 x corner pieces 90°
- 1 x capillary protection strip 5.0 long
- 4 x capillary protection corners
- 1 x installation instructions
- 1 x notice sticker for tilers

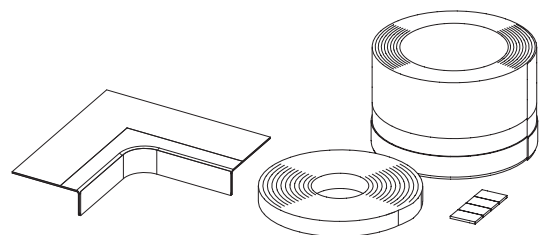

WDS ADAPTATION-SET – Order no. 6876 7611 0000

- 1 x right-hand adaptation piece
- 1 x left-hand adaptation piece

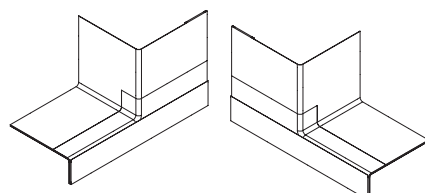

FOR PENTAGONAL SHOWER TRAYS

WDS STANDARD SET PENTAGON

Order no. 6876 7609 0000

- 1 x tray sealing strip 95 mm wide and 5.0 m long
- 3 x corner pieces 90°
- 2 x corner pieces 135°
- 1 x capillary protection strip 5.0 long
- 4 x capillary protection corners
- 1 x installation instructions
- 1 x notice sticker for tilers

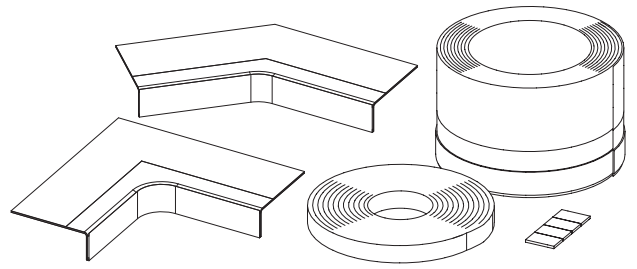

FOR QUARTER CIRCLE SHOWER TRAYS

WDS STANDARD SET QUARTER CIRCLE

Order no. 6876 7610 0000

- 1 x tray sealing strip 95 mm wide and 3.8 m long
- 1 x tray sealing strip quarter circle
- 3 x corner pieces 90°
- 1 x capillary protection strip 5.0 long
- 4 x capillary protection corners
- 1 x installation instructions
- 1 x notice sticker for tilers

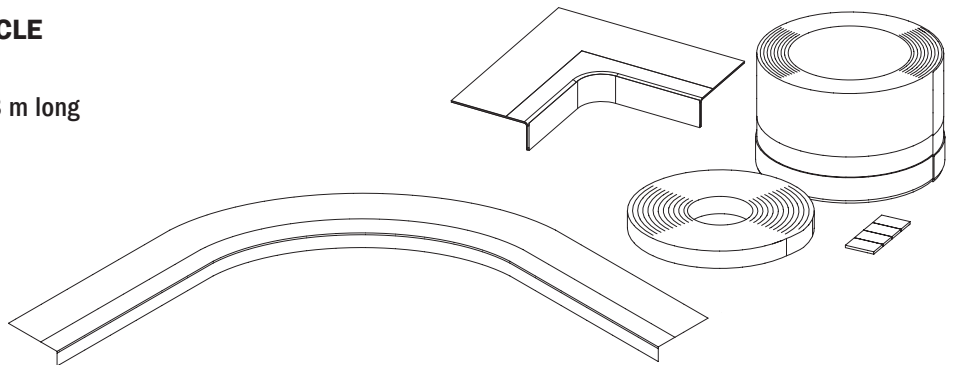

POSSIBLE INSTALLATION SITUATIONS

The tray sealing system WDS is flexible enough to be integrated with all sizes of Kaldewei's shower trays in various installation situations. For this, the Standard Sets for rectangular shower trays can be combined with the Adaptation Set.

FOR RECTANGULAR SHOWER TRAYS



1 x WDS Standard Set



1 x WDS Standard Set



1 x WDS Standard Set



1 x WDS Standard Set
1 x WDS Adaptation Set



1 x WDS Standard Set
1 x WDS Adaptation Set



1 x WDS Standard Set
1 x WDS Adaptation Set



1 x WDS Standard Set



1 x WDS Standard Set
1 x WDS Adaptation Set



1 x WDS Standard Set
1 x WDS Adaptation Set

FOR PENTAGONAL SHOWER TRAYS



1 x WDS Standard Set pentagon

FOR QUARTER CIRCLE SHOWER TRAYS



1 x WDS Standard Set quarter circle

INSTALLATION STEPS

REQUIRED TOOLS

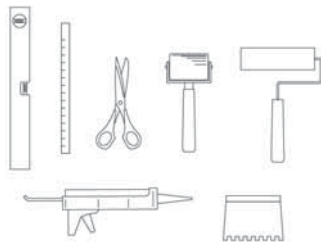

1 FIRST COAT OF SEALANT

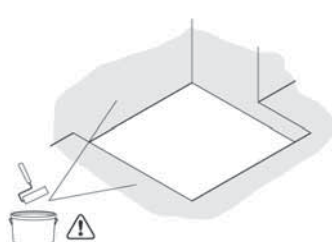

2 PLACING THE CORNER AND ADAPTATION PIECES IN POSITION

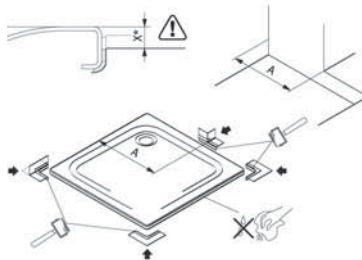

3 CUTTING THE (WALL SIDE) SEALING STRIP TO SIZE

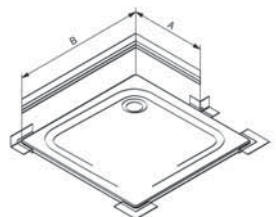

4 CUTTING THE PROTECTIVE SHEET (WALL SIDE)

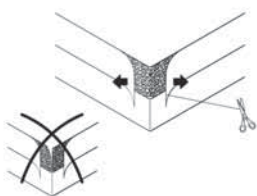

5 CUTTING THE PROTECTIVE SHEET (BATHTUB SIDE)

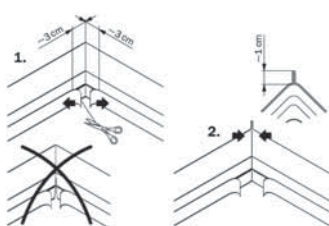

6 APPLYING THE (WALL SIDE) SEALING STRIP

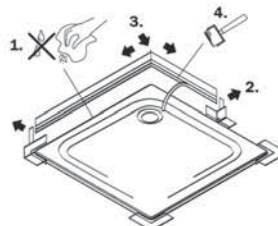

7 CUTTING THE (FLOOR) SEALING STRIP TO SIZE

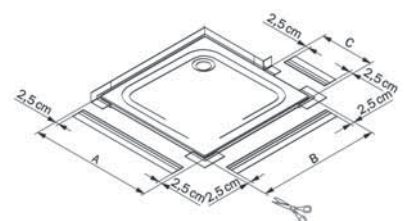

8 APPLYING THE (FLOOR) SEALING STRIP

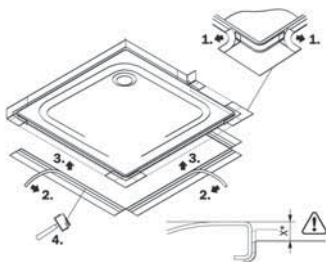

9 PUTTING THE SHOWER TRAY IN PLACE

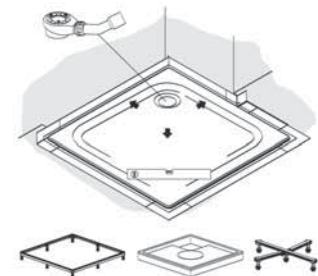

10 PRESSING ON THE SEALING STRIPS AND STICKING ON THE CAPILLARY CORNERS

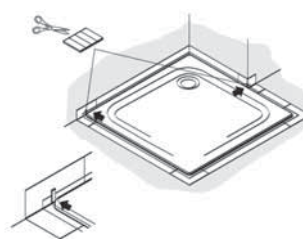

11 STICKING ON THE CAPILLARY PROTECTION STRIP

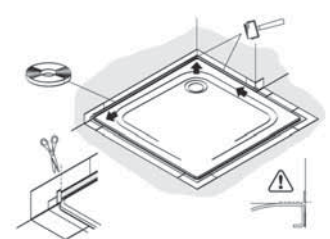

12 SECOND COAT OF SEALANT

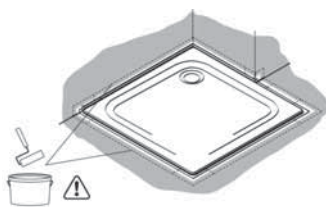

13 APPLYING THE TILE ADHESIVE (WALL SIDE) AND REMOVING THE CAPILLARY PIECES

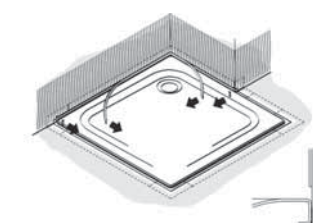

14 FITTING THE WALL TILES AND THEN APPLYING THE TILE ADHESIVE (FLOOR)

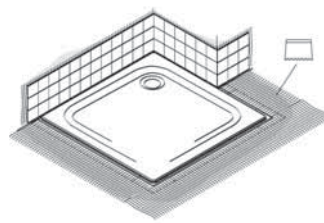

15 FITTING THE FLOOR TILES AND POSITIONING THE MAINTENANCE JOINT

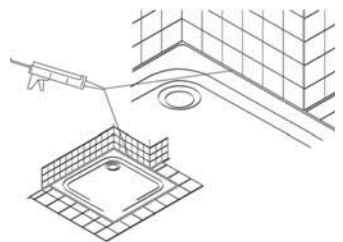

For the full installation sequence and advice please refer to the installation instructions.