

# KALDEWEI

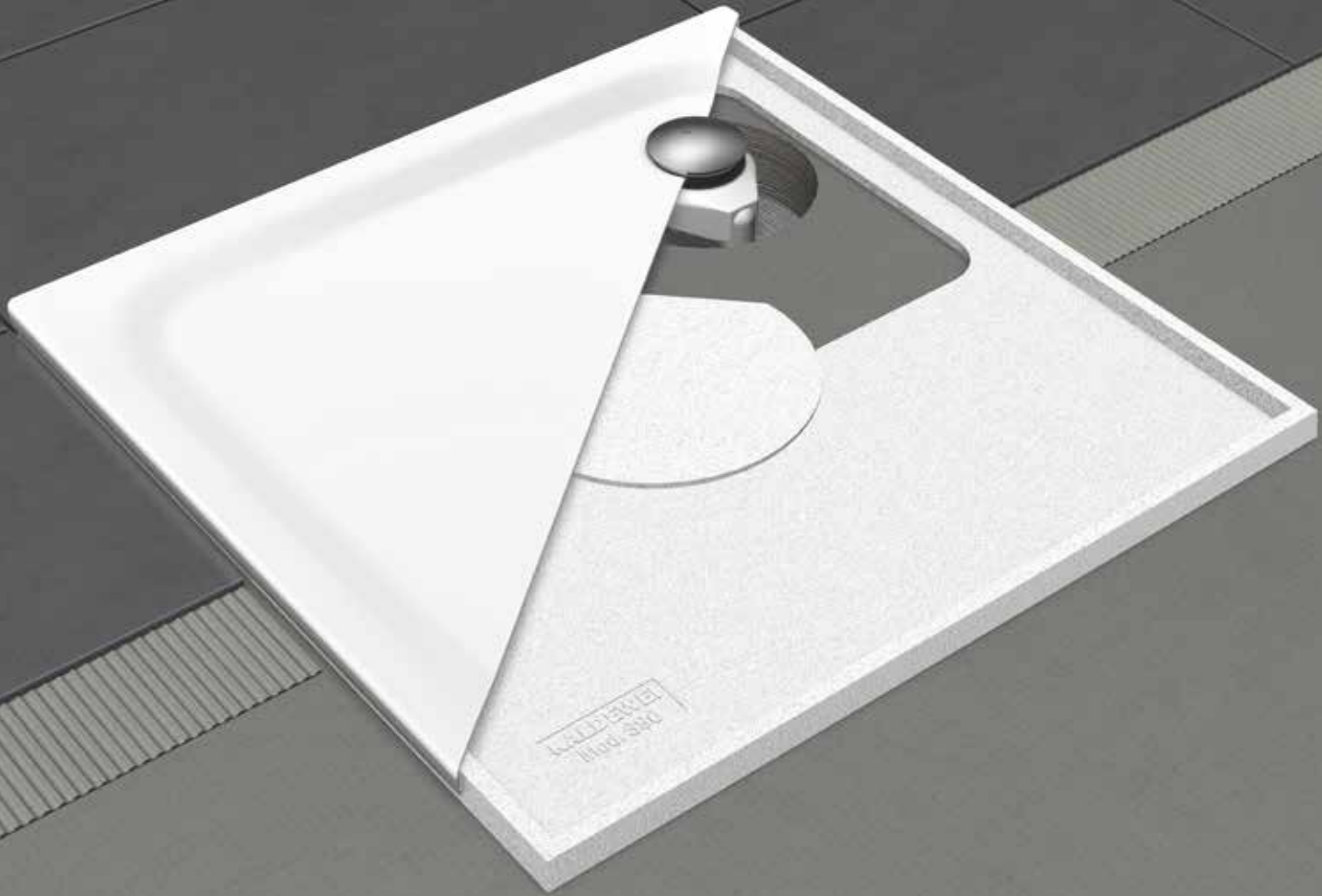

## SUPERPLAN WITH LOW PROFILE SUPPORT

The easy installation shower solution.

# SUPERPLAN WITH LOW PROFILE SUPPORT

- Easy to install, few installation steps
- Suitable for installation on different floor coverings: whether tiles, PVC or wood
- Super slim low profile design
- System solution comprising shower tray and installation system

Less is more. The SUPERPLAN with low profile support is an impressive demonstration of this principle. With 37 mm in depth (shower tray with support), this product with a minimal edge height integrates harmoniously into any room situation. The complete system consists of a shower tray and polystyrene support with a choice of horizontal or vertical waste fitting solutions. Available in seven different sizes. The shower tray can also be supplied with a choice of KALDEWEI surface finishes. The SUPERPLAN with low profile support is designed for easy installation in just a few steps, offering a simple and time-saving solution. The only floor cut-out required is a hole for the waste fitting. Position the support, bond to floor and shower tray, and finish by sealing the joints with elastic silicone. The complete system comprises all KALDEWEI components required for easy installation. The SUPERPLAN -5 is suitable for use in the most diverse installation situations. Fitted onto screed or wooden flooring, it can connect to tiles, PVC, wooden flooring or any other floor covering. If necessary, the system can even be installed on tiles.



# SIMPLE INSTALLATION

For stylish shower trays.



1

MARKING THE WASTE POSITION

Place the shower surface onto the support and move into position. Keep the shower surface at least 2 mm away from the wall. You can now mark the siphon position.



2

CUTTING A HOLE FOR THE WASTE FITTING

The cut-out for the horizontal waste fitting must allow for access to the drainage system. Connect the fitting to the drains. When using a vertical waste fitting, prepare the cut-out, but do not connect the fitting until step 5. The drainage system requires drilling a core hole.



3

SECURING THE SUPPORT TO THE FLOOR

Secure the support to the floor using a “solvent free” contact/grab adhesive, applied to the underside of the support.

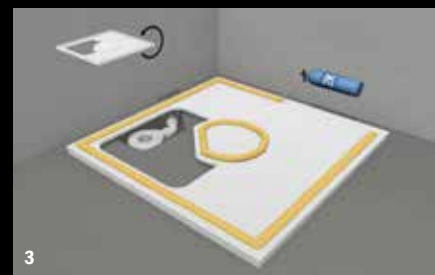

4

ADJUSTING THE SUPPORT AND BONDING TO THE SHOWER SURFACE

Turn the polystyrene support right side up and fit into the required installation position. Make sure to keep the support at least 22 mm away from the wall. Use a spirit level to adjust the support and apply silicone to the supporting surfaces.



5

POSITIONING THE SHOWER SURFACE AND CONNECTING THE FITTING

Place the shower surface onto the support. The silicone will permanently bond the surface to the support. When using a vertical fitting ensure that the connecting pipe of the fitting has been connected to the outlet pipe. For a horizontal fitting, connect the siphon trap with the gasket, the clamping ring and then the waste cover.



6

TILING AND JOINTING

The wall and floor can now be tiled. Alternatively, the shower may connect to wooden flooring or PVC. Finally, weigh down the shower tray and seal the joints connecting the tray to the wall and floor with silicone.

# PLANNING AID

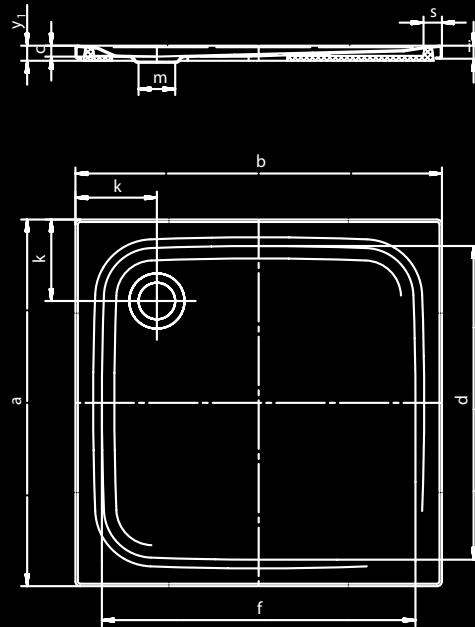

MODEL NO.		386-5	390-5	398-5	404-5	391-5	389-5	406-5
EXTERNAL LENGTH	$a$	800	900	800	900	1000	800	900 mm
EXTERNAL WIDTH	$b$	800	900	1000	1000	1000	1200	1200 mm
DEPTH	$c$	25	25	25	25	25	25	25 mm
INTERNAL LENGTH	$d$	690	790	700	790	870	700	790 mm
INTERNAL WIDTH	$f$	690	790	900	890	870	1100	1090 mm
HEIGHT OF RIM	$i$	32	32	32	32	32	32	32 mm
DISTANCE TRAY EDGE TO CENTRE OF DRAIN HOLE	$k_1; k_2$	200	200	200	200	200	200	200 mm
DIAMETER OF DRAIN HOLE		90	90	90	90	90	90	90 mm
WIDTH OF RIM		55	55	50	55	65	50	55 mm
HEIGHT WITH SUPPORT		37	37	37	37	37	37	37 mm
WEIGHT OF THE ENAMELLED SHOWER TRAY IN KG		18	22	21	24	27	25	29
ANTI-SLIP		$\varnothing$ 435	$\varnothing$ 435	$\varnothing$ 435	$\varnothing$ 588	$\varnothing$ 588	$\varnothing$ 588	$\varnothing$ 588 mm
FULL ANTI-SLIP		586 x 565	648 x 673	586 x 781	649 x 781	733 x 781	586 x 996	649 x 997 mm

WASTE FITTING DIAMETER 9 CM	horizontal	Model Ordner No.
EXTERNAL LENGTH		4088

WASTE FITTING DIAMETER 9 CM	vertical	Model Ordner No.
EXTERNAL LENGTH		4087

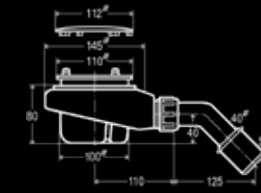

Model Ordner No. 4087

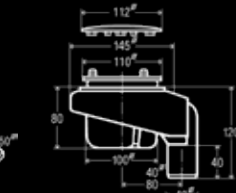

Model Ordner No. 4088

Franz Kaldewei GmbH & Co. KG  
Beckumer Strasse 33 - 35  
59229 Ahlen  
Germany  
tel. +49 2382 785 0  
fax +49 2382 785 200  
www.kaldewei.com

## AUSTRALIA

Bathe  
tel. +61 2 9518 0163  
e-mail: sales@bathe.net.au

## AUSTRIA

Kaldewei Österreich GmbH  
tel. +49 2382 785 0  
e-mail: info@kaldewei.de

## BALTIC STATES

Julijus Neufeld  
tel. +370 068573525  
e-mail: j.neufeld@ivc.lt

## BELGIUM

Egeda NV  
tel. +32 14 22 26 08  
e-mail: info@egeda.be

## CHINA

Kaldewei Far East Ltd.  
tel. +86 21 6473 7813  
e-mail: info@kaldewei.cn

## CZECH REPUBLIC

Kaldewei CS, s.r.o.  
tel. +420 226 218 590  
e-mail: info@kaldewei.cz

## DENMARK

Björn Zimmermann  
tel. +49 2382 785 278  
e-mail: bjoern.zimmermann@kaldewei.de

## FINLAND

IMG Interiors  
tel. +358 9 622 9150  
e-mail: img.interiors@co.inet.fi

## FRANCE

Raymond Piquemal, Directeur Commercial  
tel. +33 6 29 05 76 37  
e-mail: raymond.piquemal@kaldewei.com

## GREECE

Niveco AG  
tel. +30 21 0988 0180  
e-mail: nikitasvlachos@niveco.gr

## HUNGARY

Török Szaniter BT  
tel. +36 1 2501846  
e-mail: kaldewei@kaldewei.hu

## ICELAND

Trobeco  
tel. +354 5 113131  
e-mail: trobeco@mmedia.is

## INDIA

Kaldewei South East Asia Pte. Ltd.  
tel. +91 22 26855468  
e-mail: anita.shinde@kaldewei.com

## ITALY

Kaldewei Italia S.r.l.  
tel. +39 0438 179 7826  
e-mail: info-it@kaldewei.com

## JAPAN

Tform  
tel. +81 6 6632 2838  
e-mail: info@tform.co.jp

## KAZAKHSTAN

A. Sukhenko  
tel. +7 7017 133056  
e-mail: kaldewei\_kz@mail.ru

## MIDDLE EAST/NEAR EAST/NORTH AFRICA

Diane Ritzau-Starkmann  
tel. +49 171 4933624  
e-mail: diane.ritzau-starkmann@kaldewei.de

## NETHERLANDS

Wijnbeek Sanitair BV  
tel. +31 251 361 010  
e-mail: mail@wijnbeek.nl

## NEW ZEALAND

Metrix Imports Limited  
tel. +64 9 444 5656  
e-mail: info@metrix.co.nz

## NORWAY

Björn Zimmermann  
tel. +49 2382 785 278  
e-mail: bjoern.zimmermann@kaldewei.de

## POLAND

Kaldewei Polska Spółka z o.o.  
tel. +48 22 720 16 03  
e-mail: poczta@kaldewei.pl

## RUSSIA

000 Kaldewei  
tel. +7 495 232 1951  
e-mail: info.russia@kaldewei.com

## SLOVAKIA

Kaldewei CS, s.r.o.  
tel. +420 226 218 590  
e-mail: info@kaldewei.cz

## SOUTH AFRICA

Jeeves  
tel. +27 21 701 9113  
e-mail: info@jeeves.co.za

## SOUTH EAST ASIA

Kaldewei South East Asia Pte. Ltd.  
tel. +65 6899 2487  
e-mail: info@kaldewei.sg

## SOUTH KOREA

Kaldewei Far East Limited  
tel. +852 9652 1937  
e-mail: jacky.yau@kaldewei.com

## SPAIN

Kaldewei España, S.L.  
tel. +34 93 224 1150  
e-mail: info@kaldewei.es

## SWEDEN

Langenfeld Bad AB  
tel. +46 8 7020775  
e-mail: info@langenfeld.se

## SWITZERLAND

Zentrallager Schweiz  
tel. +41 62 2052100  
e-mail: lager.schweiz@kaldewei.de

## UKRAINE

B. Byshovets  
tel. +380 50 3104265  
e-mail: kaldewei@ua.fm

## UNITED KINGDOM

Kaldewei UK Ltd.  
tel. +44 1480 498 053  
e-mail: info-uk@kaldewei.com

## UNITED STATES/CANADA

Kaldewei USA Inc.  
tel. +1 866 822 2527  
e-mail: chad.novinger@kaldewei.com