

QUARTZ.DESIGN

EDIMAX

EDIMAX
CERAMICHE

La passione dà vita alle idee.

The passion brings ideas to life.

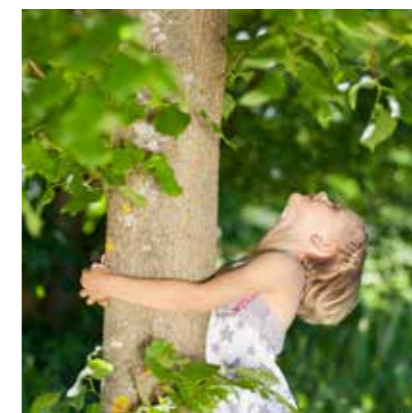

Eco-sostenibili a salvaguardia dell'ambiente.

Eco-sustainable to safeguard the planet.

Impianti fotovoltaici: 1 Mega
Photovoltaic systems: 1 Mega

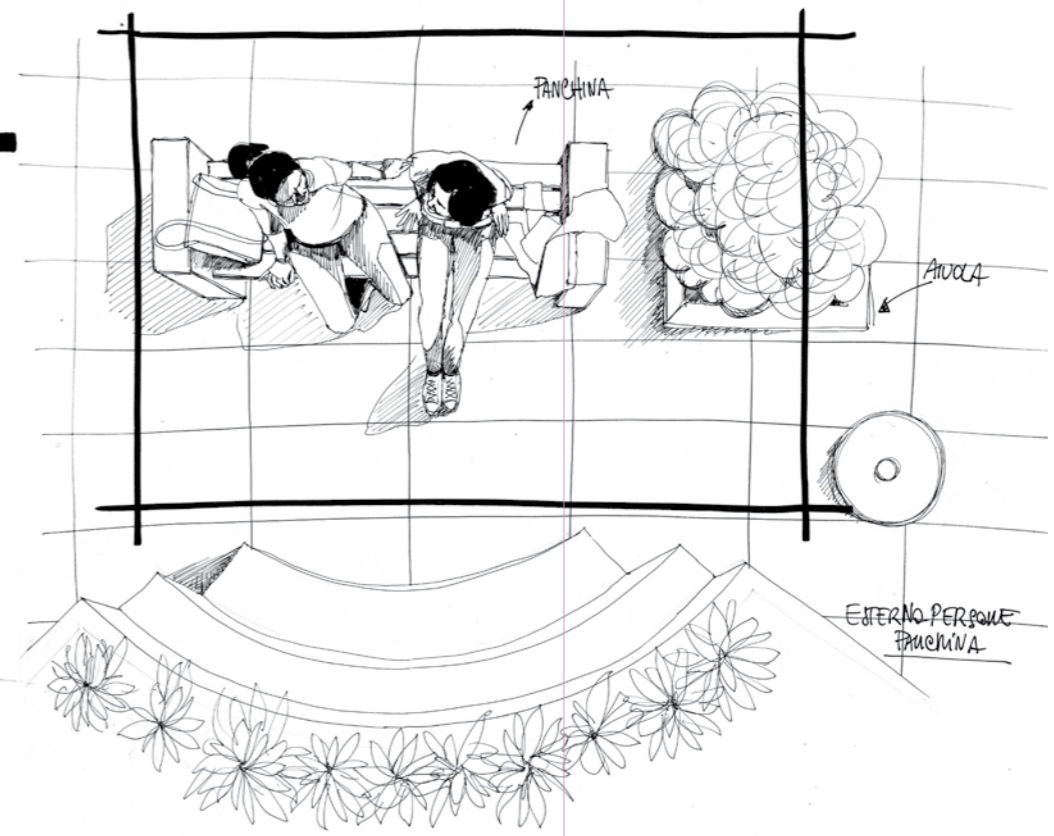
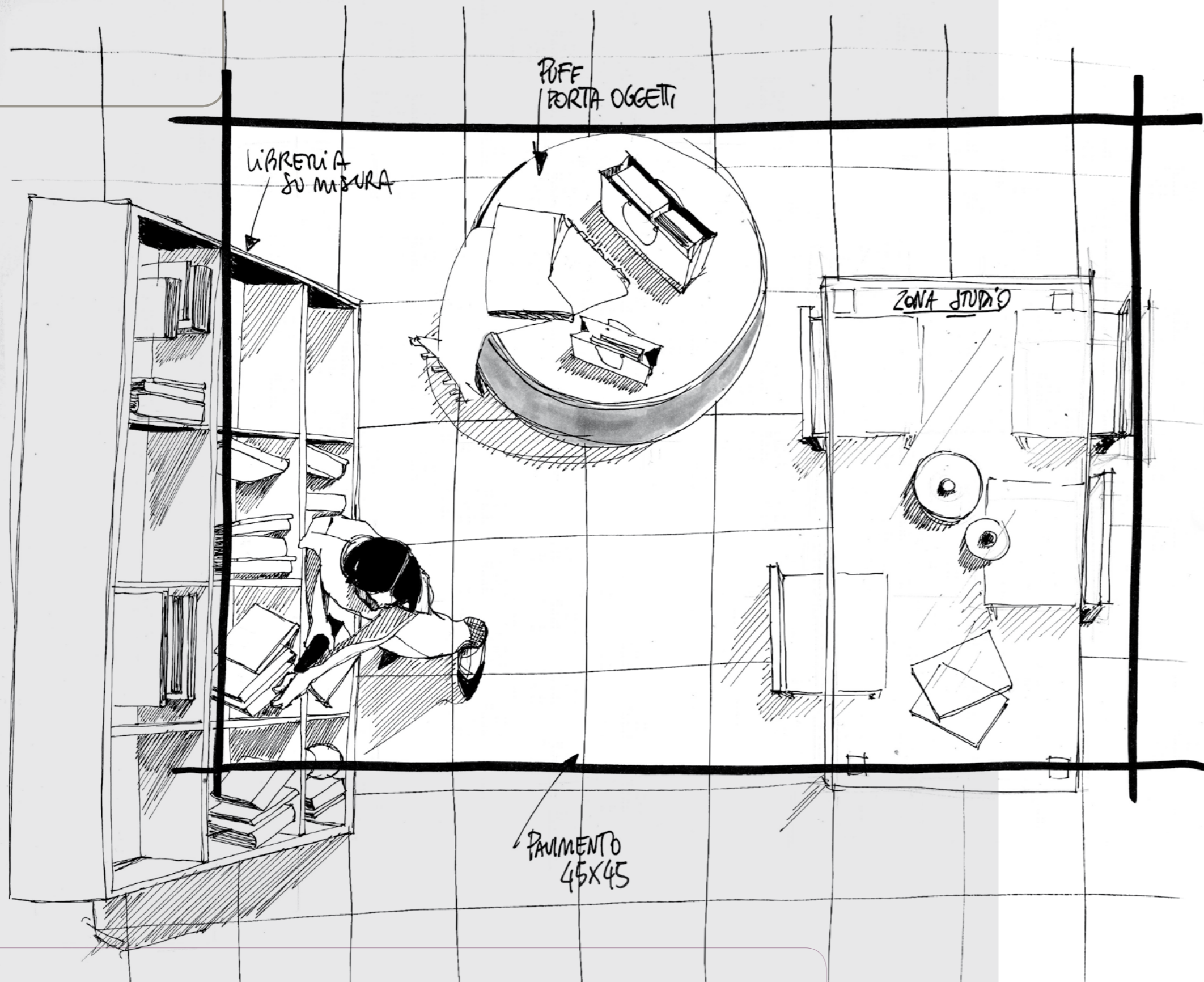

quartz.design dark

L'architettura si apre a nuove possibilità di abbinamento. Quartz Design Dark, crea suggestioni sofisticate per aree commerciali e residenziali.

Architecture opens to new possibilities of combination. Quartz Design Dark creates sophisticated suggestions for commercial and residential areas.

quartz.design dark
45,3x45,3 BTR





quartz.design dark

30x60,5 BTR



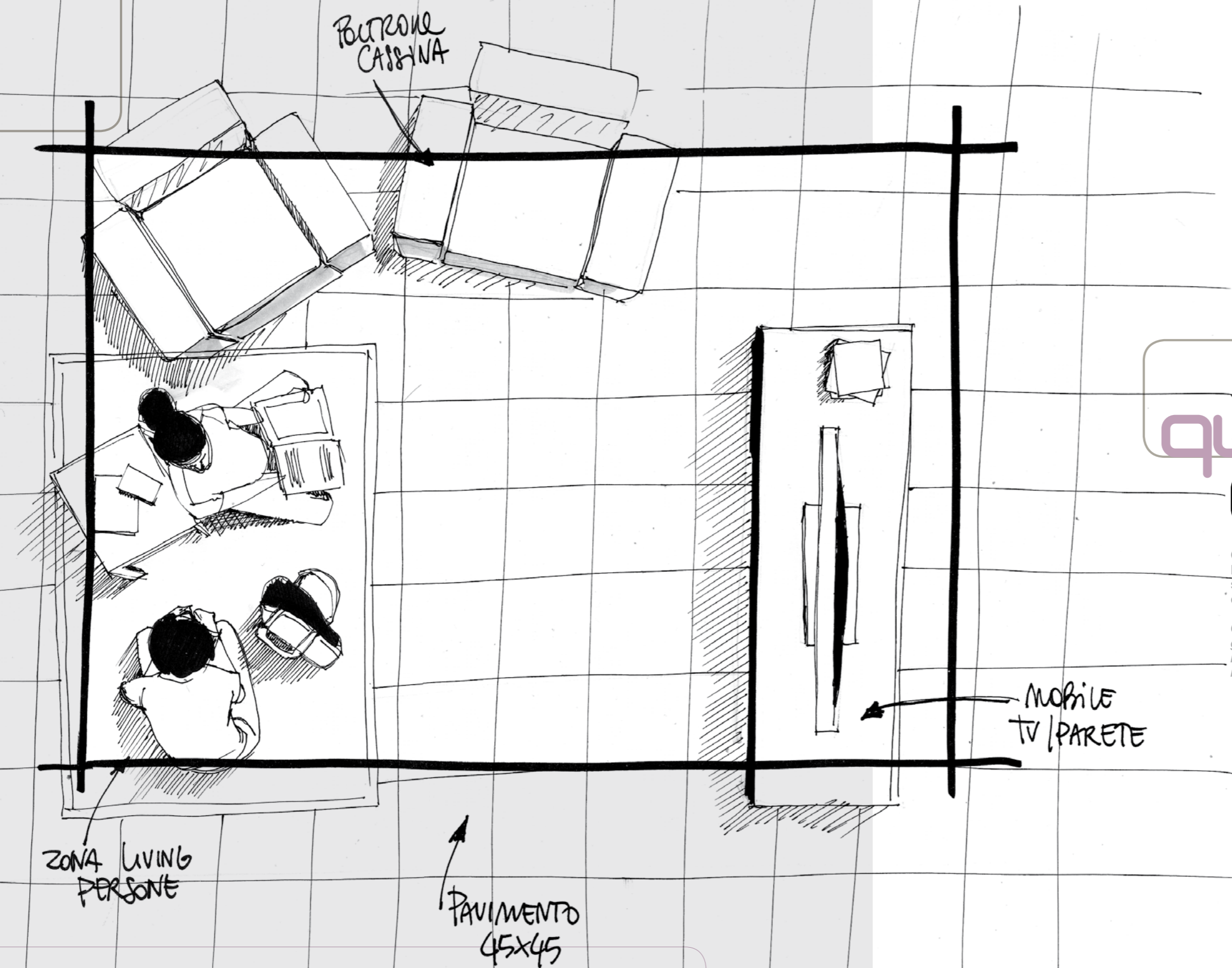

quartz.design cream

Quartz Design Cream, affascina per la sua grafica, conquista per le sue sfumature e gli ambienti si arricchiscono di autentica naturalezza.

Quartz Design Cream fascinates with its graphic, captures with its shades and makes every space precious with authentic natural charme.

quartz.design cream

45,3x45,3 BTR





quartz.design cream
45,3x75,8 BTR





quartz.design cream

45,3x75,8 BTR

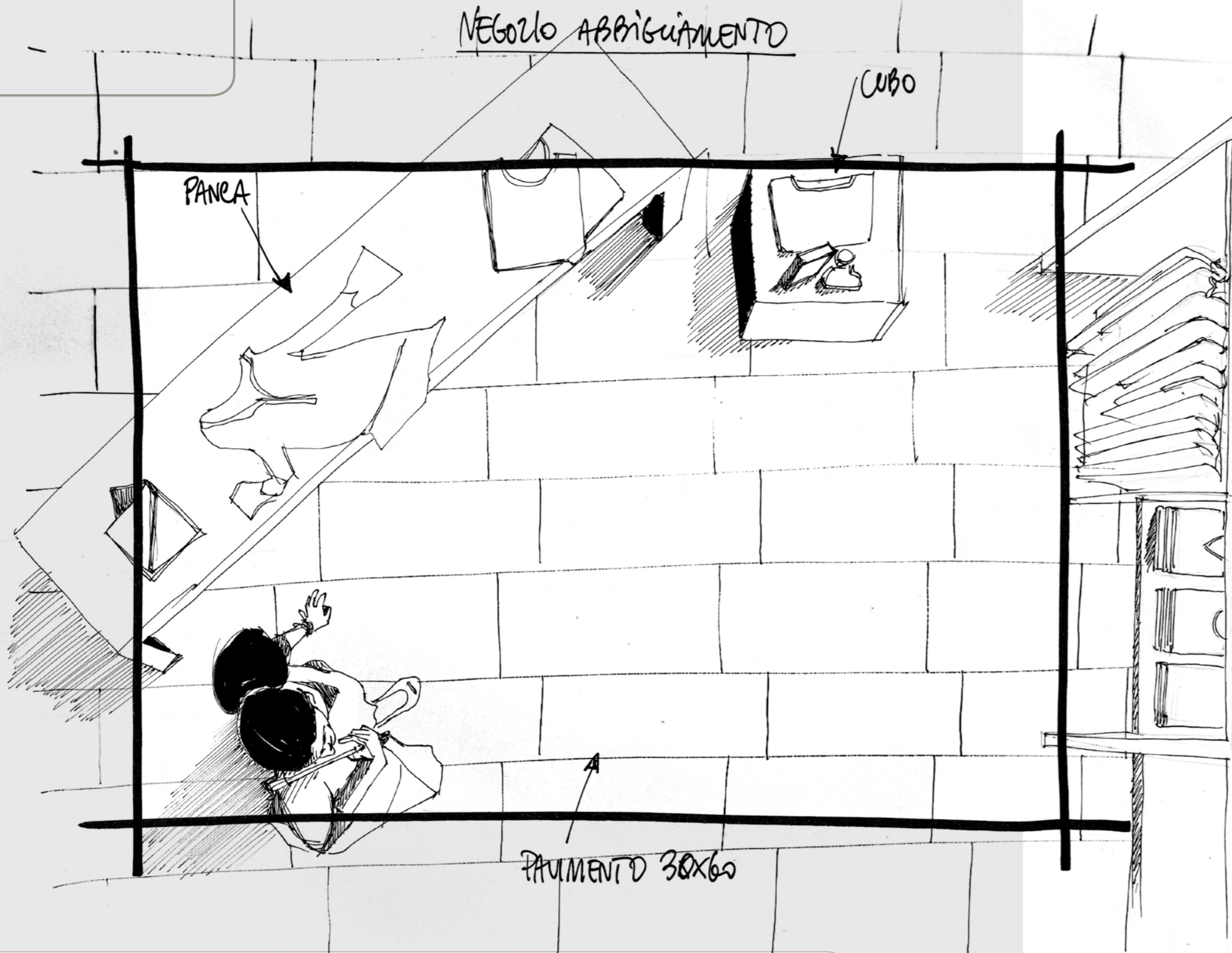

quartz.design silver

Vestire gli spazi è la naturale inclinazione di Quartz Design Silver: vero al tatto, il melange di toni e nuance valorizza gli spazi contemporanei.

Thanks to its natural inclination, Quartz Design Silver dresses up every kind of space: real at the touch, its shade and nuance variation make contemporary areas precious.



quartz.design silver

30x60,5 BTR



quartz.design silver
45,3x75,8 BTR





quartz.design silver

45,3x75,8 BTR



quartz.design silver

60,4x121 RET



QUARTZ.DESIGN DARK



2X18. Q.D Dark
60,4x121 (24"x48") RET



4MA0. Q.D Dark
45,3x75,8 (18"x30") BTR



9X01. Q.D Dark
45,3x45,3 (18"x18") BTR



6J01. Q.D Dark
30x60,5 (12"x24") BTR

6J04. Q.D Dark
30x60,5 (12"x24") ANTISLIP



3GM8. Q.D Dark
Muretto 29x30 (12"x12") ○

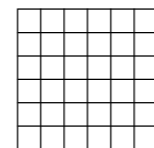

Q361. Q.D Dark
Mosaico 5x5 (2"x2")
Comp. 30x30 (12"x12") ○



6H97. Q.D Dark
Battiscopa
7,5x30 (3"x12")

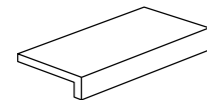

5CY2. Q.D Dark
Elemento a "L" Monolitico

5CX1. Q.D Dark
Elemento a "L" Monolitico ANTISLIP
15x30x5 (6"x12"x2")

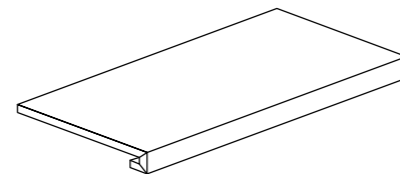

8F30. Q.D Dark
Gradino

8F33. Q.D Dark
Gradino ANTISLIP
30x60,5 (12"x24") ①

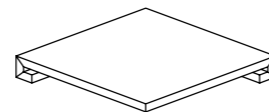

3SQ5. Q.D Dark
Ang. gradino

3SQ2. Q.D Dark
Ang. gradino ANTISLIP
30x30 (12"x12") ①

QUARTZ.DESIGN CREAM



2X17. Q.D Cream
60,4x121 (24"x48") RET



4MB0. Q.D Cream
45,3x75,8 (18"x30") BTR



9X03. Q.D Cream
45,3x45,3 (18"x18") BTR



6J03. Q.D Cream
30x60,5 (12"x24") BTR

6J06. Q.D Cream
30x60,5 (12"x24") ANTISLIP



3GM7. Q.D Cream
Muretto 29x30 (12"x12") ○

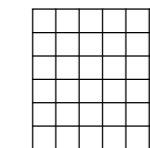

Q363. Q.D Cream
Mosaico 5x5 (2"x2")
Comp. 30x30 (12"x12") ○



6H99. Q.D Cream
Battiscopa
7,5x30 (3"x12")

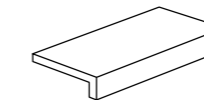

5CY4. Q.D Cream
Elemento a "L" Monolitico

5CX2. Q.D Cream
Elemento a "L" Monolitico ANTISLIP
15x30x5 (6"x12"x2")

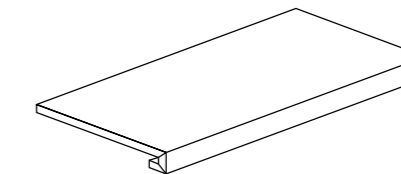

8F29. Q.D Cream
Gradino

8F32. Q.D Cream
Gradino ANTISLIP
30x60,5 (12"x24") ①

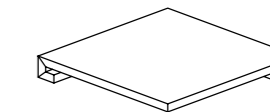

3SQ4. Q.D Cream
Ang. gradino

3SQ1. Q.D Cream
Ang. gradino ANTISLIP
30x30 (12"x12") ①

QUARTZ.DESIGN SILVER



2X19. Q.D Silver
60,4x121 (24"x48") RET



4MA9. Q.D Silver
45,3x75,8 (18"x30") BTR



9X02. Q.D Silver
45,3x45,3 (18"x18") BTR



6J02. Q.D Silver
30x60,5 (12"x24") BTR

6J05. Q.D Silver
30x60,5 (12"x24") ANTISLIP



3GM9. Q.D Silver
Muretto 29x30 (12"x12") ○

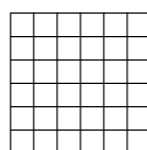

Q362. Q.D Silver
Mosaico 5x5 (2"x2")
Comp. 30x30 (12"x12") ○



6H98. Q.D Silver
Battiscopa
7,5x30 (3"x12")

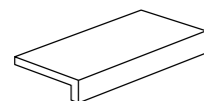

5CY3. Q.D Silver
Elemento a "L" Monolitico

5CX0. Q.D Silver
Elemento a "L" Monolitico ANTISLIP
15x30x5 (6"x12"x2")

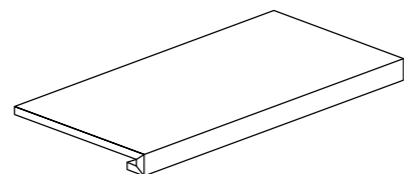

8F31. Q.D Silver
Gradino

8F34. Q.D Silver
Gradino ANTISLIP
30x60,5 (12"x24") ①

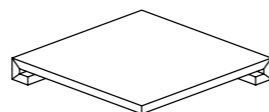

3SQ6. Q.D Silver
Ang. gradino

3SQ3. Q.D Silver
Ang. gradino ANTISLIP
30x30 (12"x12") ①

INFORMAZIONI GENERALI GENERAL INFORMATION

- Prodotto in porcellanato smaltato con impasti colorati. Bordi BTR e bordi rettificati. Superfici naturali e superfici antiscivolo.
Coloured body glazed porcelain tiles. BTR conic reversed edges and rectified edges. Natural surfaces and antislip surfaces.
- Tutte le misure sono nominali. Le conversioni in pollici sono approssimate ed arrotondate.
All sizes are nominal. The conversions into inches are approximate and rounded off.
- Le confezioni contengono il prodotto con diverse sfumature di tono, venature, strutture e direzionalità. Al fine di ottenere il migliore effetto estetico, si consiglia, durante la posa, di prelevare le piastrelle alternativamente da scatole diverse.
The boxes contain the item with different shade variegations, veins, structures and direction. When you lay down the tiles, in order to obtain the best blend of the colours, we advice you to take the tiles alternatively from different boxes.
- Per i formati rettangolari consigliamo una posa sfalsata massimo di 1/4 della lunghezza.
For the rectangular sizes we suggest an installation pattern at a maximum of 1/4 of the entire length.
- Bordi BTR: nella posa in composizione è consigliato prevedere fughe di 3-5 mm, in monoformato almeno 2 mm.
Conic reversed edges: when you lay down it is suggested to use grouts of 3 to 5 mm in composition, in single size at least 2 mm.
- Bordi rettificati: nella posa mono e multi-formato è consigliato prevedere fughe di almeno 2 mm. - *Rectified edges: when you lay down single and multi sizes it is suggested to use grouts of at least 2 mm.*
- Ci riserviamo la facoltà di modificare e/o eliminare i formati, i calibri, gli spessori e le grafiche in qualsiasi momento senza che si renda necessaria una espressa comunicazione scritta.
We reserve the right to modify and/or remove the sizes, the calibers, the thickness and the graphics anytime, with no obligation of a further notice in writing.
- I toni degli articoli campionati sono puramente indicativi pertanto le variazioni di tono e di superficie non possono costituire motivo di contestazioni.
The shades of the samples are purely representative of the item itself so the shades variation and the surfaces variations cannot constitute the reason for a claim.

SIMBOLOGIA SYMBOL

BTR: bordi a trapezio rovesciato
BTR: conic reversed edges

RET: rettificato
RET: rectified

○ prodotto tagliato
○ cut item

① piastrella con torelo incollato (**solo su richiesta**). Per uso esterno è necessario adottare tutte le misure per una posa a regola d'arte secondo usi e norme in vigore. - *Tile with glued torello (on request only). For external use it's necessary to adopt all according to usage and regulations in force.*

PROGETTO BTR

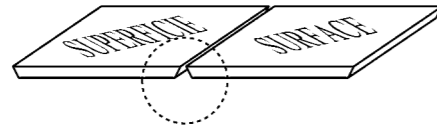

Le piastrelle sono prodotte con la speciale caratteristica dei Bordi a forma di Trapezio Rovesciato. L'originale formatura dei Bordi a Trapezio Rovesciato consente la posa più ravvicinata (almeno 2 mm), conferendo alla superficie la sensazione di continuità. Per evitare eventuali scheggiature, si raccomanda la massima attenzione e di non appoggiare le piastrelle in verticale senza l'originale imballo.

The tiles are produced with a particular system in order to obtain reversed conic edges. The original characteristic of the side of the tile, produced with the reversed conic edges enables the installation with very small joints (at least 2 mm) and gives to the surface a sensation of continuity. To avoid possible chips it is recommended to pay the maximum attention and not to place the tiles vertically without their original packing.

CARATTERISTICHE TECNICHE TECHNICAL CHARACTERISTICS

													ANTISLIP
Spessore	Assorbimento d'acqua	Carico di rottura	PEI Resistenza all'abrasione superficiale	Resistenza agli sbalzi termici	Resistenza al cavillo	Cessione Piombo Cadmio	Conducibilità Termica	Resistenza al gelo	Resistenza chimica	Coefficiente dinamico di frizione	Coefficiente statico di frizione	Resistenza allo scivolamento	Resistenza allo scivolamento
Thickness	Water absorption	Modulus of rupture	Resistance to surface abrasion	Resistance to thermal shock	Crazing resistance	Emission Lead Cadmium	Electrical Conductivity	Frost resistance	Chemical resistance	Dynamic coefficient of friction	Static coefficient of friction	Slip resistance	Slip resistance
	ISO 10545-3	ISO 10545-4	ISO 10545-7	ISO 10545-9	ISO 10545-11	ISO 10545-15	UNI E.N. 1745	ISO 10545-12	ISO 10545-13	ANSI A.137	ASTM C 1028	DIN 51130 DIN 51097	DIN 51130 DIN 51097
10 mm	< 0,5% Bla	43 N/mm2	5	Garantita Guaranteed	Garantita Guaranteed	Pb < 0,1 Cd < 0,01	0,675 < CT < 0,715 W/mk	Garantita Guaranteed	GA (V) GLA (V) GHA (V)	> 0,42	Asciutto / Dry = 0,65 Bagnato / Wet = 0,61	R10 A + B	R12 A + B + C

QUARTZ.DESIGN MERCHANDISING



Catalogo **QUARTZ.DESIGN**



Ark Kit S **QUARTZ.DESIGN**



Ark Kit L **QUARTZ.DESIGN**



Expo Step **QUARTZ.DESIGN B**



Expo Step **QUARTZ.DESIGN A**

EDIMAX
CERAMICHE



EDIMAX
CERAMICHE

GRUPPO BETA S.p.A. Strada Statale 569 n° 234 – 41014 Solignano di Castelvetro (MO) – Italy – Tel. 059 748911 – Fax 059 748990 – www.edimax.it – info@edimax.it